

Virginia Horse Center Facility Guide



487 Maury River Road Lexington, Virginia 24450
540-464-2950 www.vahorsecenter.org

Welcome to The Virginia Horse Center

The Virginia Horse Center has been the crown jewel of the Commonwealth's \$2 billion equine industry for more than 35 years. The expansive venue hosts more than 100 events annually including local, national, and internationally rated horse shows, educational clinics, rodeos, receptions, and fundraisers in addition to a variety of community-centric events.

Our 600-acre facility boasts breathtaking views of the Blue Ridge, a 4000 seat coliseum, capacity for 1000 horses, eleven show rings, and an internationally rated cross-country course. We are located just 3.2 miles from downtown Lexington, a tourism destination filled with award-winning accommodations, exquisite restaurants, and quaint historic districts. Events attended by approximately 400,000 visitors annually take place 285 days per year promoting the Commonwealth's equine industry and acting as a catalyst for economic development locally and regionally.



The Virginia Horse Center Offers...

A world-class competition venue surrounded by a natural environment ideal for equine well-being.

- 600 grassy acres of pristine Virginia countryside bordering the Maury River
- Stall capacity for 745 horses in safe, permanent stabling with capacity for a total of 1000 horses in permanent and temporary stabling combined
- New synthetic footing in six of 13 arenas
- Meticulously maintained footing, discipline-specific
- Sequestered vehicular traffic to ensure safe pathways between arenas and barns
- Superior ventilation in all stabling areas for the comfort of horses and exhibitors
- Conveniently located wash racks in every barn
- Centrally located farrier stations
- Extensive trail system for relaxing hacks down to the river
- On-site emergency equine ambulatory service

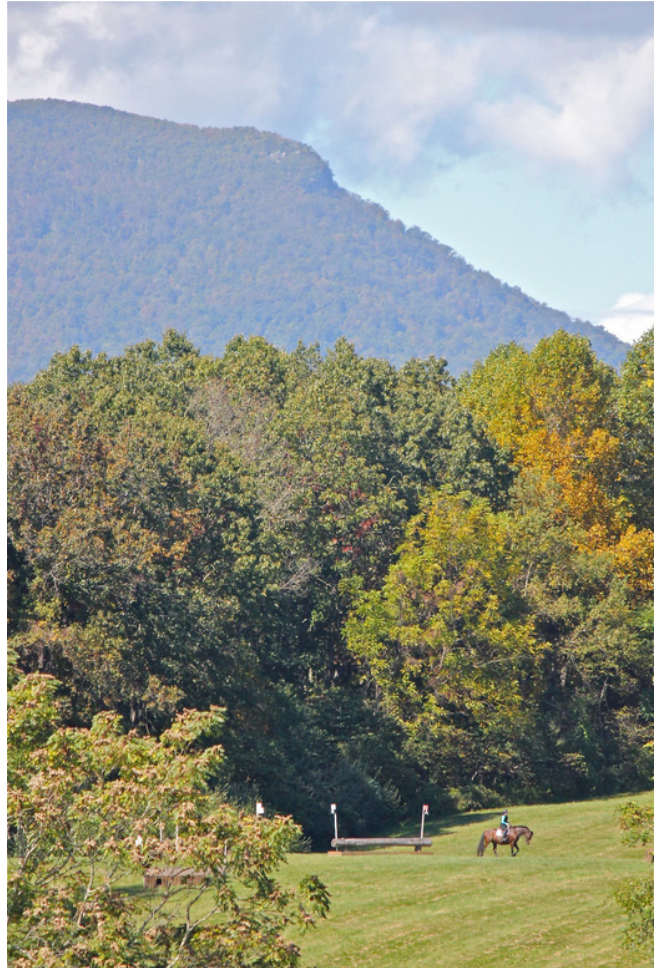

A Desirable, Amenity-Rich Destination



The Virginia Horse Center is located just 3.2 miles from Historic Downtown Lexington and its award-winning boutique hotels, numerous restaurant choices, and cultural offerings. Visitors can enjoy museums, tours, and the historic campuses of Washington & Lee University and Virginia Military Institute.

Additional amenities include:

- Multiple national chain hotels within a ten-minute radius of the Horse Center, many with exhibitor discounts
- Area attractions and recreational opportunities within thirty minutes of the Horse Center include Natural Bridge, Goshen Pass, the Blue Ridge Parkway, Civil War historic sites, rivers, lakes, hiking trails, wineries, breweries, and galleries
- Golf Course access at The Lexington Country Club (open to the public)
- On-site dining and catering services including a 9000 sq. ft. meeting and banquet space adjacent to a commercial kitchen
- On-site campgrounds with water and electric hook-up



A Convenient Location



- Situated at the junction of I-81 and I-64 in Lexington, within a days' drive of two-thirds of the population of the United States
- Close to several major metropolitan areas and transportation hubs including Washington, D.C., Raleigh/Durham and Winston/Salem, North Carolina, and Charleston, West Virginia

An Exceptional Track Record

Since opening in 1987, the Virginia Horse Center has hosted more than 2300 events of state, national, and international importance including:

- The USEF Pony Medal Finals
- Numerous AA & WCHR shows
- The Sally B. Wheeler National Breeding Championship
- VHSA/EMO Insurance Equitation Finals
- The North American Young Rider Championships
- National Barrel Horse Association Colonial Nationals
- United States Pony Club National Championships East
- USEF Four-in-Hand Championships
- Virginia International 3-Day Event / Numerous CCI* and CIC** Horse Trials
- The AQHA East Coast Championships
- The USDF Region 1 Championships
- National Walking Horse Association Championships
- Arabian Horse Association Sport Horse Nationals
- The USEF/American Vaulting Association National Championships...and many more!

What Our Exhibitors Have to Say...



"I am a 3rd generation horse trainer, we have been showing at this facility since it opened. It is the best place we come to show horses and we show all over the southeast. The new improvements to the barn, arenas, and facility...they have definitely put this place over the top!" - Matt Shiflet, North Carolina

"The first thing about the Horse Center that you notice is everyone is friendly, nice... just the camaraderie of the people. [You notice] how kind they are and you enjoy being around them, and the facility itself is fantastic, but the people make it fantastic." - Chris Wynne

"No matter which way you turn, you have something beautiful to feast your eyes upon." - Marcella Gruchalak



"Woof, Woof Woof, Woof!" - Mr Pibbles



"HUGE congratulations and gratitude for the footing improvements and new seating area; it was fabulous!" - Lauren Sprieser

"I think this event is one of the few that highlights all of the beauty that is the Virginia Horse Center. Often visitors don't wander beyond the main complex, but there is so much to see in the surrounding hills." - David Taylor, re: Virginia Horse Trials

Facility Map

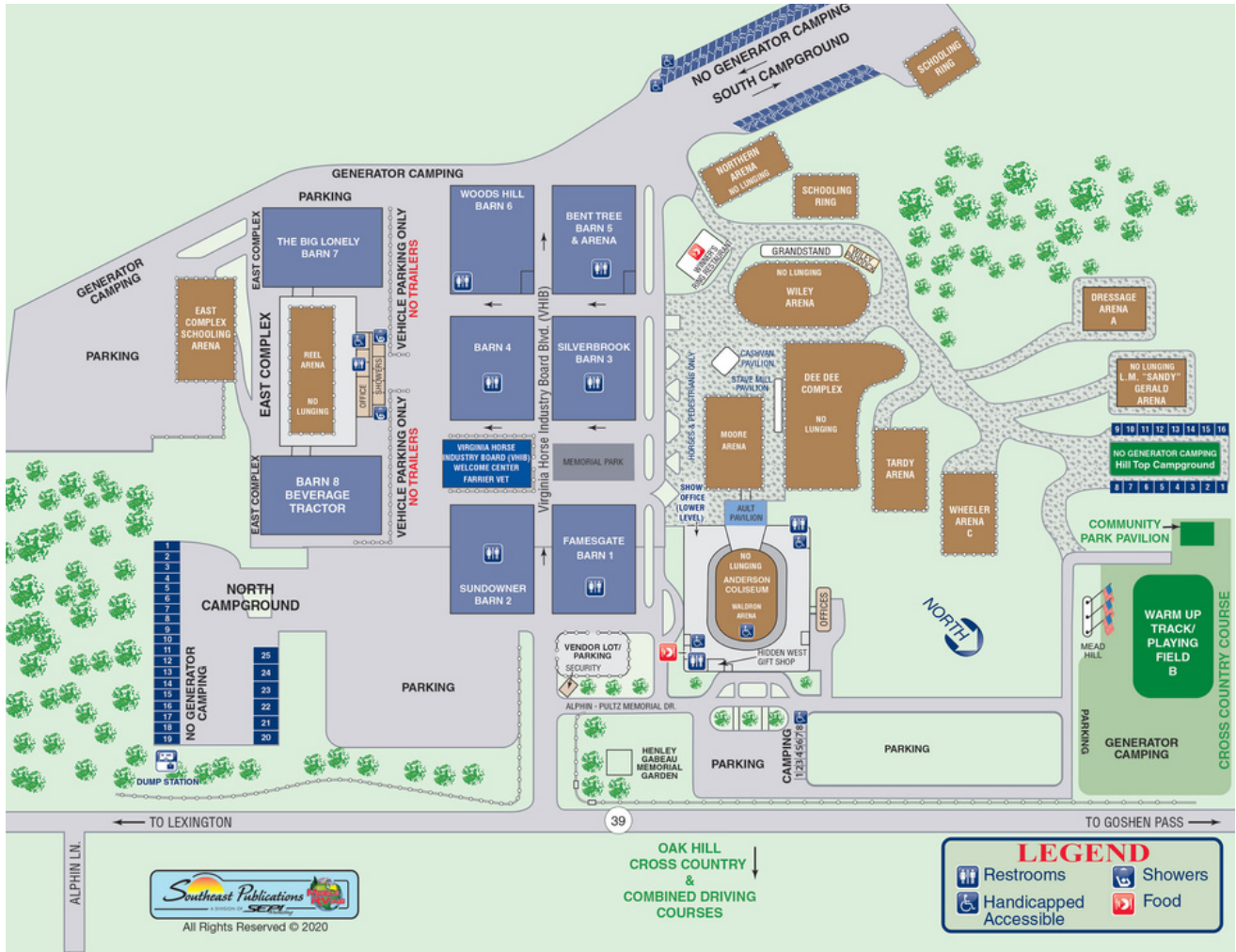

Anderson Coliseum



Seating capacity: 4000

40' wide concrete concourse for vendors

Waldron Arena

Anderson Coliseum
Synthetic-Sand Footing



Appomattox Mezzanine

Anderson Coliseum

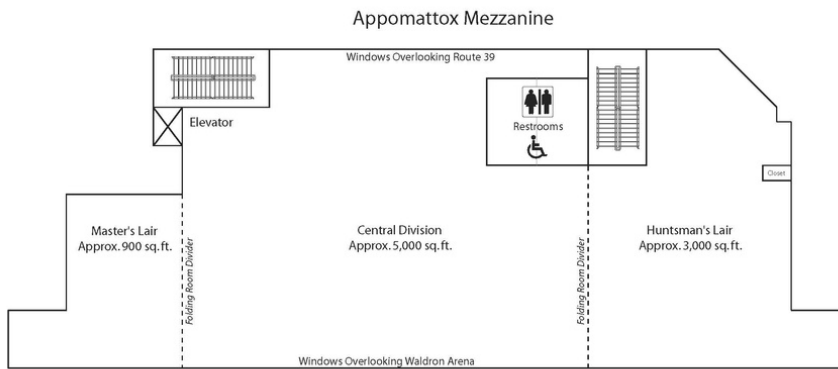

Located upstairs in the Howard P. Anderson Coliseum, the Appomattox Mezzanine is a 9000 square foot banquet and event space complete with sound system and kitchen access.



Isabel de Szinay Complex

58,047 Sq. Feet Eurotex™ Footing



Stave Mill Pavilion

Isabel de Szinay Complex



Oak Hill Cross-Country & Combined Driving Course

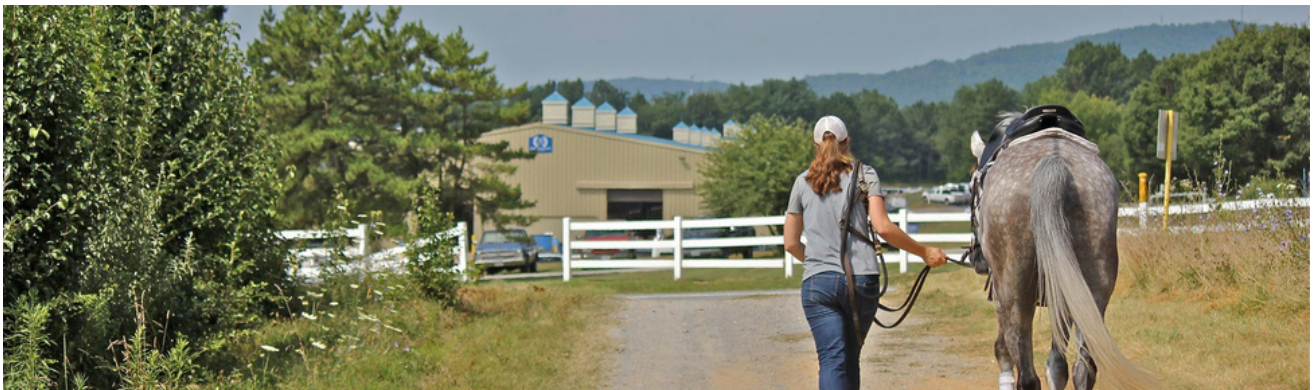

East Complex



The East Complex includes two barns (Big Lonely barn and Barn 8) along with an additional 260' x 120' indoor show arena, which may be accessed directly from both barns. There is also a 180' x 70' warm-up arena inside the Big Lonely barn (Barn 7). The East Complex allows for simultaneous indoor events to take place in separate areas of the Horse Center.

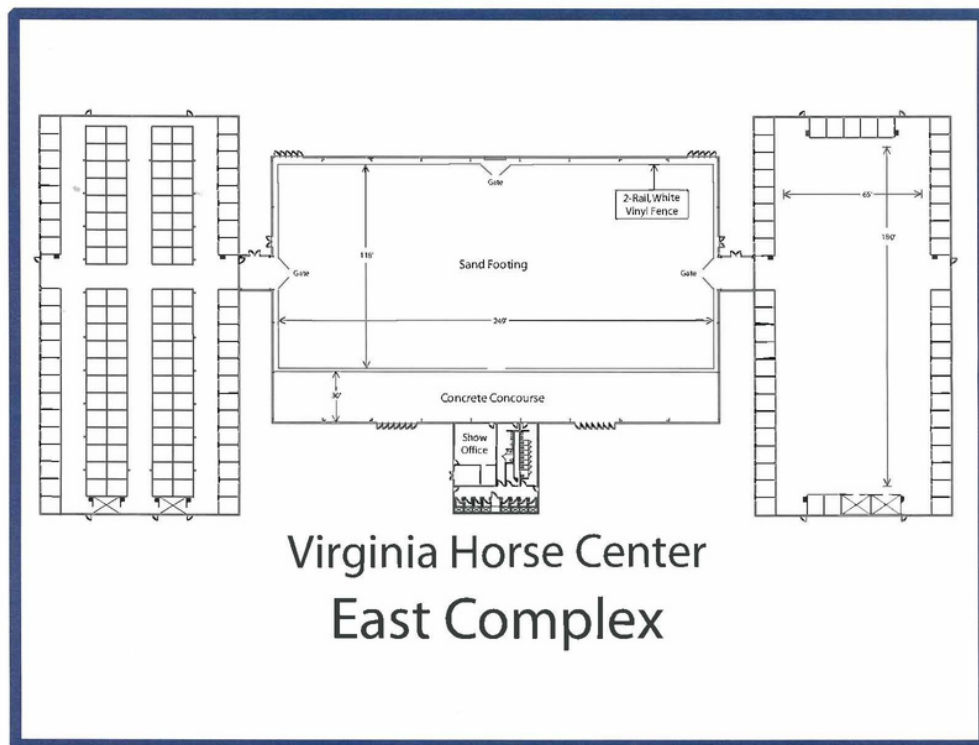

Wiley Arena

300' x 130'

Grandstand Seating Capacity: 1000



Moore Covered Arena

220' x 96'



Famesgate

Full Renovation 2019-2020



Bent Tree Farm

Full Renovation 2020-2021



Memorial Park

Dedicated in 2020, Memorial Park creates a peaceful oasis in the heart of the complex. Several benches contain charging stations and free wifi is available to all.



Virginia Horse Center

Ring Dimensions

*Bent Tree Arena (Barn 5) 180' x 64'6"

Big Lonely Arena (Barn 7) 180' x 70'

*Dressage/Jumping Arena A 250' x 96'

*L.M. "Sandy" Gerlald Arena 230' x 160'

East Complex/Reel Arena 260' x 120'

*Isabel de Szinay Complex 58,047 Sq. Ft.

Moore Arena 220' x 96'

Northern Arena 260' x 120'

*Tardy Arena 295' x 102'

Waldron Arena (in Anderson Coliseum) 300' x 150'

Wheeler Arena 250' x 96'

*Wiley Arena 300' x 130'

Woods Hill Arena (Barn 6) 180' x 64'6"

**New synthetic footing*

Stall Dimensions

Length x Width 10' x 12'

Height 7' 10"

Wall Width 5 7/8"

Door Dimensions

Coliseum Roll-Up Doors 8'10"

Ault Roll-Up Doors 13'10"

Food Service & Catering

The Virginia Horse Center's Catering and Events staff offer a wide variety of event planning and food service options to Horse Center patrons. From event concessions and boxed lunches to barn parties and exhibitor receptions, the Virginia Horse Center's top-quality food and service will enhance the show experience for exhibitors, spectators, volunteers, vendors, and management alike. In addition, VHC Catering is available to cater private events including weddings, rehearsal dinners, business meetings, receptions, and parties in the Virginia Horse Center's Appomattox Mezzanine or at other locations on the Horse Center grounds.



Vendors

The Virginia Horse Center offers ample indoor vendor space in both the Anderson Coliseum and East Complex, as well as outdoor vendor spaces. The price of vendor space is determined by each show manager and vendors contract with shows individually.



Campgrounds

There are two campgrounds on the Virginia Horse Center property. The main campground is on the southwest side of the facility behind barns 5 and 6, with additional camping in the northeastern corner. The Horse Center currently has over 90 spaces available between the two locations, all with water and electric hookups. A dump station is also available.



Parking

The Virginia Horse Center has plentiful parking for hundreds of trailers as well as convenient, **free** parking for spectators.



Our Community & Our Impact

Since 1985 the Virginia Horse Center has been an integral part of the Central Shenandoah Valley Community. The facility is available for community-centric events, hosting several each year including agricultural fairs, 4-H events, Balloons Over Rockbridge, and the Annual Holiday Gift Basket program for Rockbridge County families.



In 2019, an Economic Impact Study was conducted by Chmura Economics and Analytics to accurately assess the 2019 economic impact of the Virginia Horse Center on the City of Lexington, the County of Rockbridge, and the Commonwealth of Virginia.

The results of this study indicate that the total economic impact on the City of Lexington is an estimated \$7.4 million, supporting 67 jobs. In the County of Rockbridge, the estimated economic impact is \$47.7 million, supporting 518 jobs. Across the Commonwealth of Virginia, the estimated economic impact of Virginia Horse Center-related activities is estimated to be \$94.9 million, supporting 896 jobs.



The Economic Impact of the Horse Industry in Virginia



- Total value added to the Virginia Economy: \$2 billion
- Total employment impact: 38,874 jobs
- Direct employment impact: 29,232 jobs
- Direct contribution to GDP: \$1.2 billion
- 183,643 horses reside in Virginia, ranking it 13th in terms of equine population by state
- Horse ownership, equine institutions & profit-making organizations, and tourism spending by participants and spectators combined for a \$3.32 billion economic impact
- A total of 30.5% of households, or one million Virginians, contain horse enthusiasts
- Number of Virginia residents volunteering their time for horse-related activities: 62,000
- 600,000 acres of land in Virginia is used for horse-related purposes

Contact Information

Chief Executive Officer



Mr. Glenn T. Petty
Mobile: 303-513-8467
Email: gpetty@horsecenter.org

General Manager



Mr. Leroy Troxell
Phone: 540-464-2959
Email: Ltroxell@horsecenter.org

Shipping & Mailing Address

Virginia Horse Center
487 Maury River Road
Lexington, Virginia 24450

Main Phone

540-464-2950

General Email Address

info@horsecenter.org

Website

www.vahorsecenter.org

Gallery



Gallery





487 Maury River Road Lexington, Virginia 24450
540-464-2950
www.vahorsecenter.org